



## Finishes Bodywork Enamel (V400CAR) (V400FAS)

This is another amazing product from the Ambro-Sol "Paint" line. It gives a new and vibrant appearance to vehicles and motorbike exteriors. Ideal for every type of plastic, resistant to scratches and it dries rapidly

**FINISHES BODYWORK** - It is a professional enamel that is resistant to scratches, alcohol and gasoline. Ideal for painting tractors, agriculture machines (AGRI) any material associated with rims/wheels of motorcycles and cars (CAR). The paint can be used for repainting or renewing bumpers, side panels, and spoilers (FAS).



**Product under V.O.C. regulation**  
Sub-category: special finish  
Edge value of VOC: 840 g/Litro

**APPLICATION:**

WOOD, METAL AND PLASTICS (FAS).

### Technical Specifications:

Quantity	400 ml
Box / Case	6 pcs
Aspect	Tin-Plate can containing pressurized liquid
Chemical Nature	Quick drying Acrylic Paints
Color	Various – color card
Odor	Typical of solvent
Relative density at 20°C	0,73 ÷ 0,77 g/ml
Flash point	Extremely Flammable < 0° C
Writes under the bottom	Barcode, batch date, product name
Pressure	at 20°C 5,5 ± 0,5 bar
Pressure	at 50°C 8,0 ± 0,5 bar
Viscosity Ford Cup	12"-15"
Dry Residual inside can	13% - 32%
Granulometry Grindometer	0 - 2 Micron
Glossiness	7 - 80 Gloss (glossmeter angle 60°)
Thickness 1 layer	13-24 Micron
Thickness 3 layer	36-54 Micron
Working Temperature	+5°C / +100°C (peaks 120° C)
Drying times t=20°:	Dry out dust 15 minutes
	Dry on touch 30 minutes
	In depth 24 h
Child-proof safety cap	
Colored Token and ring	
Can suitable for different nozzles	
Check the color and the product type on the cap or the bottom of the can.	

### RECOMMENDATION FOR USE:

Carefully clean and sand the surface to help increase adhesion of the product. The surface must be completely dry before applying the product, use the product at a humidity rate not higher than 80%, then select the right product for your specific application

Apply the correct primer for both surface and product:

Apply V400PRIMER1 for wheels and rims, after 48 hours apply V400CAR.1

Apply V400PRIMER2 for spoilers and other plastic materials, after 48 hours apply V400CAR.1

Apply V400PRIMER3 or V400STUCCO for bodywork surfaces and metallic parts, after 48 hours apply V400FAS AGRI line.

## HOW TO USE:

- Vigorously shake the can for at least 1 minute, until you hear the inner marbles move freely. It is also suggested to occasionally shake the cylinder even during use;
- Carefully clean the surface before application;
- Test in a hidden area to verify compatibility of the surface with the paint.

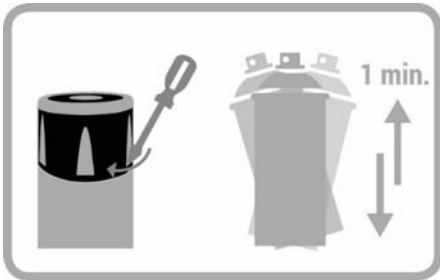

Remove the secure seal on the cap, to open the spray



**Actuator according to the product.**

**Dispensing: Linear or adjustable.**

**Quantity product dispensed from minimal to extensive.**

**Dispensing type: narrow cone to large.**

**Spray type: nebulized.**

## SPRAY:

- Apply a first hand / coat light to improve coverage and adherence, to reduce the possibility of dropping. Apply from a distance of 20-30 cm;
- After a few moments apply a second horizontal hand/coat immediately followed by a third vertical hand / coat;
- Let dry a few minutes;
- After use, it's advisable to spray for 2/3 seconds with the spray upside down, to avoid the block of the actuator;
- After 24h, proceed with the normal use of painted piece.

## MODALITY OF STORAGE

Before using: stock the product in a dry location and don't stock it with a temperature under 5°C and over 45°C, after the use, keep containers closed. In the original package, the product can be conserved for 24 months (warranty). The product doesn't expire.

After the first usage: conserve in a fresh and dry location, away from hot spring. Keep out of reach of children.

This information, even if reliable, must be considered only approximate. We are not responsible for the wrong use of the product, or the violation of any license. Before using, the users should verify the suitability of the product for its specific use.

**BEFORE USE, CONSULT THE SAFETY DATA SHEET OF THE PRODUCT**